

# AUSILIA BASIN DS006BI

CE EN 14688:2015

# GLOBO



Ceramic antibacterial effect  
BATAFORM®



Glazed product with  
CERASLIDE®

Cod. **DS006BI**

Ergonomic basin 67,5x45 h17,5 cm. One hole arranged for three tap holes, provided with elbow support. No overflow. Wall-hung installation. Can be combined with hand or pneumatic mechanism for basin inclination. Weight 18 Kg

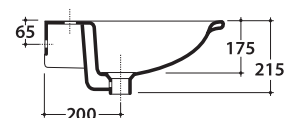
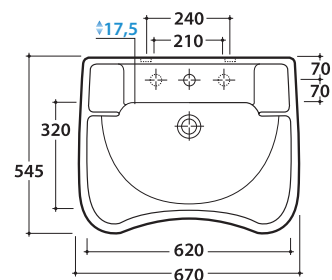

Cod. **RA051CR**

Chrome siphon round shape 1 1/4. Weight 0,5 Kg

Cod. **DS142**

Long single level mixer

Cod. **DS149**

Couple of fixed shelves for item DS006



Cod. **FI024CR**

Chromed valve drain for basins without overflow. Weight 0,5 Kg



Cod. **DS141**

Folding hand device for item DS006 (UNI EN 12182:2012). Weight 10 Kg



Cod. **DS145**

Folding hand device with gas piston for item DS006 (UNI EN 12182:2012). Weight 8 Kg



Cod. **DS143**

Flexible plastic siphon for ergonomic washbasin. Weight 0,5 Kg